

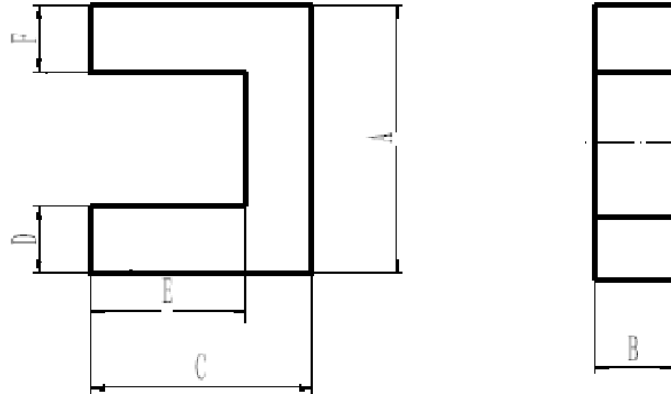

UF cores

UF18



CORE SETS

CORE DIMENSIONS (mm)

Dimensions (mm)						Weight (g)
A	B	C	D	E	F	
18.0±0.3	4±0.1	3.3±0.1	2.9±0.1	2.2±0.1	2.9±0.1	0.68

Characteristic

Grade	AL (nH/N ²)
	f=100kHz U=1.0V N=20Ts, Φ0.35 mm
DN120L	22±25%



UF cores

UF48. 4

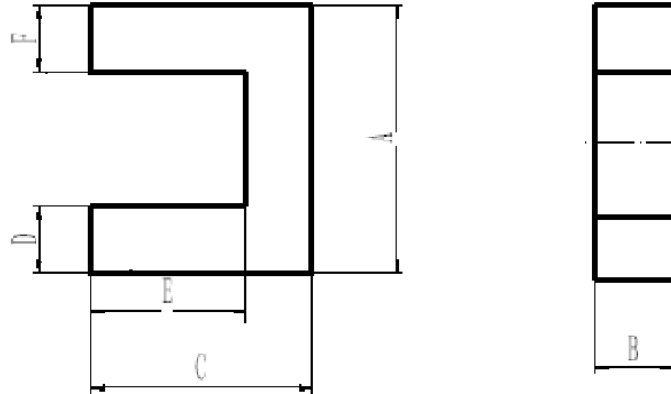

CORE SETS

CORE DIMENSIONS (mm)

Dimensions (mm)						Weight (g)
A	B	C	D	E	F	
48.4±0.5	10.0 ±0.2	6.0 ±0.2	5.5 ±0.2	2.5 ±0.2	5.5±0.2	10.24

Characteristic

Grade	AL (nH/N ²)
	f=100kHz U=1.0V N=20Ts, Φ0.35 mm
DN35H	64±25%



UF cores

UF9.7

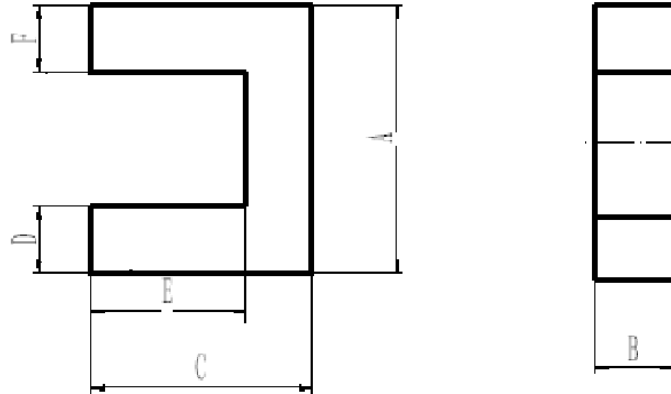

CORE SETS

CORE DIMENSIONS (mm)

Dimensions (mm)						Weight (g)
A	B	C	D	E	F	
9.7±0.2	2.7±0.1	7.45±0.1	2.7±0.1	4.4±0.1	2.7±0.1	0.75

Characteristic

Grade	AL (nH/N ²)
	f=100kHz U=1.0V N=20Ts, Φ0.35 mm
DN85H	175±25%



UF cores

UF11.5

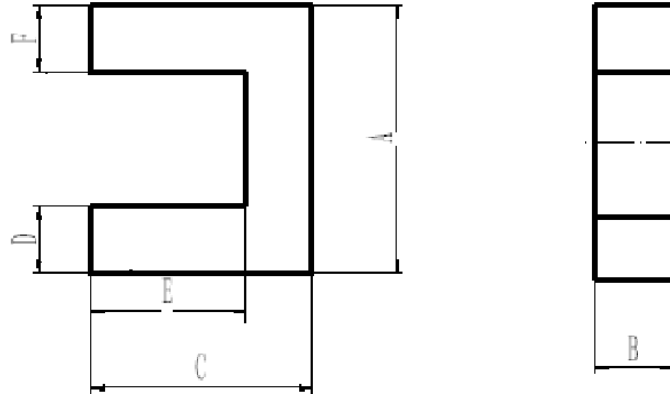

CORE SETS

CORE DIMENSIONS (mm)

Dimensions (mm)						Weight (g)
A	B	C	D	E	F	
11.5±0.2	3.4 ⁺⁰ _{-0.3}	14.15±0.2	4.3±0.1	10.55±0.2	4.3±0.1	2.34

Characteristic

Grade	AL (nH/N ²)
	f=100kHz U=1.0V N=20Ts, Φ0.35 mm
DN120L	300±25%