

BH 型磁芯 · BH Cores

ORDERING CODE SYSTEM

BH 16 × 9 × 28.5 DN35H

Material
C dimension
φ B dimension
φ A dimension
Core type

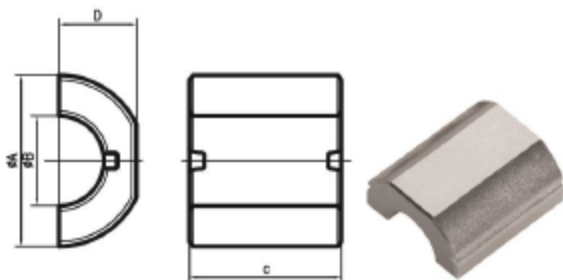

Figure 1

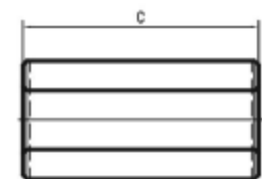

Figure 2

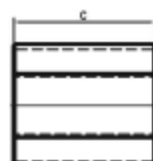

Figure 3

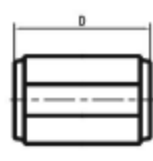

Figure 4

型号 Part number	图号 Fig.	尺寸 Dimensions(mm)					重量 Wt(g/set)
		φA	φ B	C(可调)	D	E	
BH 10 × 5 × 20.3	2	10.0 ⁺⁰ -0.4	5 ± 0.2	20.3 ± 0.2	4.55 ⁺⁰ -0	3.1ref	2.68
BH 12 × 7.4 × 15.2	2	12 ± 0.3	7.4 ± 0.4	15.2 ± 0.3	5.6 ± 0.2	5.0	2.39
BH 16 × 8 × 16	1	16.3 ± 0.3	8.3 ⁺⁰ -0.3	16.0 ± 0.4	8.3 ⁺⁰ -0.3	/	5.92
BH 16 × 9 × 28.5	2	16.0 ± 0.4	9.0 ± 0.4	28.5 ± 0.6	7.8 ± 0.4	6.0	10.3
BH 16 × 8 × 13.1	1	16.3 ± 0.3	8.3 ⁺⁰ -0.3	13.1 ± 0.2	8.3 ⁺⁰ -0.3	/	5.12
BH 16 × 9 × 29.8	2	16 ± 0.3	9.0 ± 0.4	29.8 ± 0.3	8.1 ± 0.1	4.0	13.4
BH17X11X28.2	2	17.0 ± 0.3	11.0 ± 0.4	28.2 ± 0.3	8.2 ± 0.2	4.5	8
BH18X6X28A	4	18 ± 0.3	6.0 ± 0.3	28 ± 0.4	8.5 ± 0.3	5.9	10
BH 18 × 10 × 28A	1	18 ± 0.3	10ref	28 ± 0.3	9.0 ⁺⁰ -0.3	/	14.6
BH 20 × 13.4 × 29	2	20 ± 0.3	13.4 ± 0.4	29 ± 0.3	9.7 ± 0.2	4.86	17.2
BH 25 × 15 × 12A	1	25 ± 0.8	15 ± 0.8	12 ± 0.3	12.0 ± 0.15	/	8.6
BH 26 × 13 × 29.6	2	26 ± 0.3	13 ± 0.4	29.6 ± 0.3	13.5 ± 0.2	7 ± 0.15	31.1
BH33X15.5X34A	3	33.0 ± 0.4	15.5 ± 0.4	34.0 ± 0.5	15.0 ± 0.2	/	52.04
BH38X20.6X40	3	38.0 ± 0.4	20.6 ± 0.4	40.0 ± 0.5	17.8 ± 0.4	13.3	76.96
BH 40 × 21 × 35A	1	20 ± 0.8	21.0 ± 0.8	35 ± 0.5	18.91ref	/	79
BH 40.4 × 27.8 × 16A	1	40.4 ± 0.6	27.8 ± 0.4	16 ± 0.3	20.2ref	/	26.9
BH41X21.5X41A	3	41.0 ± 0.6	21.5 ± 0.4	41.0 ± 0.8	19.0 ± 0.3	/	94.1
BH54X25.5X45A	3	54.0 ± 0.6	25.5 ± 0.4	45.0 ± 0.8	25.0 ± 0.3	/	190.8

注: 其它尺寸可以根据需求来制作

REMARK: OTHER SIZE ARE AVAILABLE UPON REQUEST